

REV.	DATE	DESCRIPTION
0	4/12/18	PRELIMINARY

PRELIMINARY  
SITE PLAN #4

Building Addition for  
PARKSIDE ASC  
2731 Park Street  
Jacksonville, Florida

Allyn C. Tidball, P.E.  
Civil Engineering Site Investigation  
2278 Laurel Grove Lane  
Orange Park, Florida 32073  
352-244-3700  
al@ac-tidball.com

SHEET  
PR-4

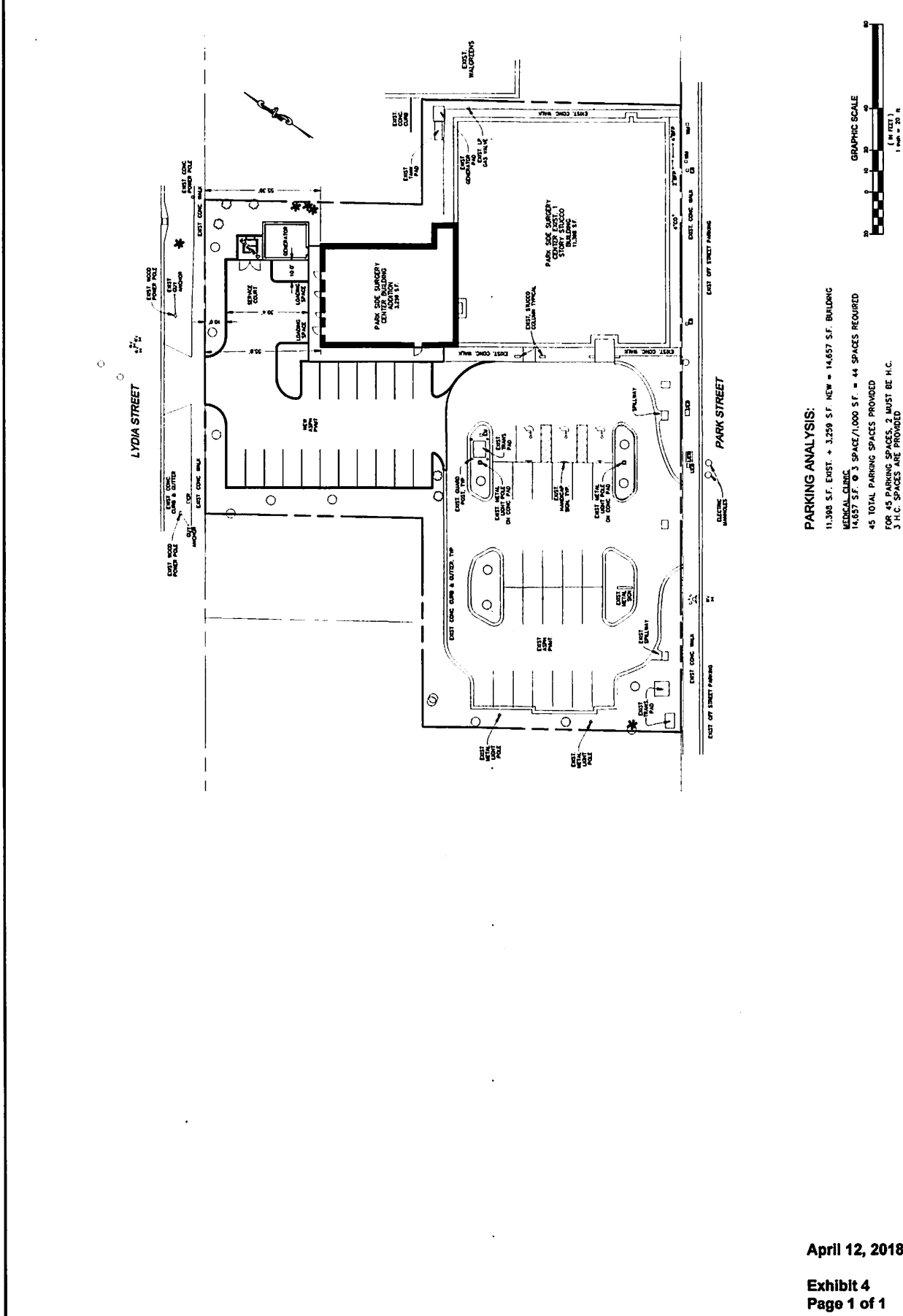

**PARKING ANALYSIS:**  
 11,380 S.F. EXIST. + 3,259 S.F. NEW = 14,637 S.F. BUILDING  
 MEDICAL CLINIC  
 14,637 S.F. @ 3 SPACES/1,000 S.F. = 44 SPACES REQUIRED  
 45 TOTAL PARKING SPACES PROVIDED  
 FOR 45 PARKING SPACES, 2 MUST BE H.C.  
 3 H.C. SPACES ARE PROVIDED



PRELIMINARY - NOT FOR  
CONSTRUCTION